

ERDC-200-12

Performance data

- Motor rated speed: 3000 rpm
- DC power connector
- Start-up possible in any position



Type	Working moment [kgcm]	Unbalance force [N]	Performance [W]	Max. current [A]	Voltage [VDC]	Weight [kg]
ERDC-200-12	4,2	2070	190	16	12	6,0

Table 1: Performance data

Dimensions

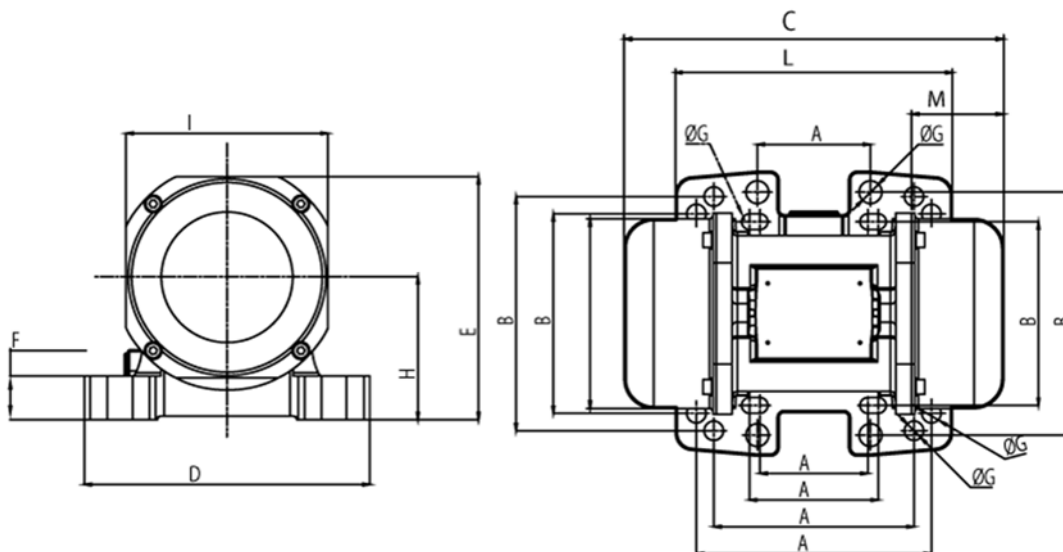

Dimension	A	B	C	D	E	F	G	H	I	L	M	N	Screw
	[mm]	[mm]	[mm]	[mm]	[mm]	[mm]	[mm]	[mm]	[mm]	[mm]	[mm]	[mm]	
ERDC-200-12	62-74	106	218	164	140	25	9	82	116	159	53	110	M8
	65	140					13						M12
	115	135					11						M10
	135	115					11						M10

Table 2: Dimensions